

Cinque Port Town of New Romney



Mrs C. Newcombe
Town Clerk
and
Responsible Financial Officer

Town Clerk's Office
Town Hall
New Romney
Kent TN28 8BT

Tel: New Romney 01797 362348

Ref: MW/7001

26th March 2025

Dear Councillor,

A MEETING OF NEW ROMNEY TOWN COUNCIL'S PLANNING & ENVIRONMENT COMMITTEE WILL BE HELD IN THE ASSEMBLY ROOMS, CHURCH APPROACH, NEW ROMNEY TN28 8AS ON WEDNESDAY 2nd April 2025 AT 6.45PM

You are hereby summoned to attend the above-mentioned meeting of New Romney Town Council's Planning and Environment Committee to consider the under-mentioned business.

Signed:

Sadie Walmsley

Miss Sadie Walmsley
Planning Clerk

Email: planning.clerk@newromney-tc.gov.uk

The afore-mentioned meeting will commence at 6.45pm.

Members of Public are welcome to join this meeting.

PLEASE NOTE: New Romney Assembly Rooms and New Romney Town Hall have restricted access for people with limited mobility; please enquire for details.

Anyone displaying any symptoms of Covid-19 should NOT attend the meeting.

PUBLIC PARTICIPATION AT TOWN COUNCIL MEETINGS

1. Who can participate in a New Romney Town Council meeting?

Members of the Public and Press may attend this Council meeting, except at such times as certain sensitive personal, legal or contractual matters may be considered in private and confidential session, when Members of the Public will be required to leave the meeting.

A maximum of THREE members of public may also participate by submitting a question at a meeting. The question must relate to a matter affecting the parish of New Romney and/or its residents. Each submission must last no longer than 3 minutes in total.

Any such question should be delivered to the Council by way of a written statement submitted by email by midday on the day of the Council meeting - to be read out during the meeting. The question submitted should be mindful of the 3 minute speaking time available. The reading of the question will allow for any mid-sentence delivery to be completed before being stopped at the three minute deadline. If any Member of Public does not have access to email, a question can be submitted by email by a representative on their behalf.

Any such questions should be emailed to: planning.clerk@newromney-tc.gov.uk by midday on the day of the Council meeting.

2. How and when do I have to let the council know that I want to participate?

You will need to give written notice (via email or post) that you would like to participate by 3pm on the Friday before the meeting, providing your name and contact details and a summary of what your question subject will be. No late notifications can be accepted.

3. What happens if more than three local residents want to participate by submitting questions to the Council?

The system will operate on the basis of “first come, first served” as identified by the Clerk. You will be notified as soon as possible after your ‘notification of wish to

participate' has been received as to whether or not you will be able to participate (by reading out your submission).

4. What will happen at the Council meeting?

Your question will be read aloud during the agenda item: Public Questions. If it is possible for the Chairman to provide a response to your question at the meeting, he/she will do so. If it is not possible to provide a response at that time, a response will be provided in writing – usually within 28 days of the meeting taking place.

Agendas and reports for meetings will be available at least 3 working days and usually 7 weekdays before the date of the meeting on the Town Council website. Any supplementary sheets will be available the day before the meeting and can be viewed at www.newromney-tc.gov.uk

THE LAWS OF LIBEL AND SLANDER

- These laws are very strict.
- If, in public, you say something about a person that is not true, even if you believe it to be true, you may be sued and have to pay compensation. Therefore, you need to be very careful about any criticism you wish to make of people in any written submission.
- Councillors are able to speak more freely and bluntly while in Council or Committee meetings than members of the public.
- You, as a member of the public, do not have the same protection.

NEW ROMNEY TOWN COUNCIL
PLANNING AND ENVIRONMENT COMMITTEE MEETING
2nd April 2025
AGENDA

1. APOLOGIES:

To receive and note apologies of councillors unable to attend.

2. DISPENSATION TO PARTICIPATE:

To receive and note any applications granted by the Town Clerk, on behalf of the Town Council, for dispensation to participate in Meetings of New Romney Town Council.

3. DECLARATIONS OF INTEREST:

Councillors to declare any Disclosable Pecuniary Interests or Other Significant or Personal Interests they may have in items on the agenda this evening.

4. ADJOURNMENT OF MEETING:

To consider formal adjournment of the meeting of the Committee for a maximum period of fifteen minutes to allow for an allocated public session.

5. PUBLIC QUESTIONS:

Members of the public may put questions to the Chairman of the Committee for a period of fifteen minutes regarding matters to do with the town of New Romney and its coastal areas of Littlestone and Greatstone, including items on the agenda. Any Councillors who have declared an “Other Significant Interest” in matters to be discussed at this meeting will also have the opportunity to speak within the session set aside for public participation, in accordance with the Town Council’s Code of Conduct Item 5(3)(b), which reads as follows:

“ Where you have an Other Significant Interest in any business of the Authority, you may... make representations, answer questions or give evidence relating to the business, provided that the public are also allowed to attend the meeting for the same purpose.”

6. RE-CONVENING OF MEETING:

To formally re-convene the meeting of the Committee.

7. MINUTES (Encs*):

To approve the minutes of the Planning and Environment Committee Meeting held on 12th March 2025 (attached hereto).

8. PLANNING CLERK'S REPORT (Encs*)

To receive and note the Planning Clerk's report.

9. SCHEDULE OF PLANNING APPLICATIONS (Encs*)

To consider planning applications attached hereto and including any received subsequent to issue of this Agenda and make any recommendations as deemed appropriate.

10. SCHEDULE OF LICENCING APPLICATIONS

To receive and note schedule of Licencing Applications.

**11. FOLKESTONE AND HYTHE DISTRICT COUNCIL REPORTS
DECISIONS/MATTERS (Encs*)**

(i) To received and note Hythe and Folkestone District Council's Reports, Decisions and Matters.

12. ENVIRONMENTAL MATTERS (Encs*)

To receive written reports and, within the remit of the Committee, take any such action(s) thereon as may be deemed necessary.

(i) Sea water quality and surface water flooding update, if available.

13. REPORTS OF WORKING PARTIES (Encs*)

(i) To receive and note the written reports of any working parties reporting to the Planning and Environment Committee and to take any such action(s) thereon as may be deemed necessary.

MINUTES
of
A Meeting of the Planning and Environment Committee
Held in the Assembly Rooms, Church Approach, New Romney
on 12th March 2025
Commencing at 6.45pm

PRESENT:**Councillors:**

K Terry, P Coe, J Rivers, S O'Hare, P Carey, J Davies and J Houston

In the Chair:

Councillor K Terry

In Attendance:

Planning Clerks

-

Mrs G Hall and Miss S Walmsley

Members of public -

x 2

592/2024-25 **APOLOGIES FOR ABSENCE**

Apologies for absence were received and noted, as follows:

Cllr Rev Cn McLachlan due to personal reasons.

Cllr L Phillips due to personal reasons.

593/2024-25 **DISPENSATION TO PARTICIPATE**

No new applications for Dispensation to Participate had been received.

594/2024-25 **DECLARATIONS OF INTEREST**

Councillor Coe declared a personal interest in relation to planning application 25/0106/FH due to being a customer of the business.

595/2024-25 **ADJOURNMENT OF MEETING**

It was not necessary to adjourn the meeting as no questions had been received in writing.

596/2024-25 **PUBLIC QUESTIONS**

None received.

597/2024-25 **RE-CONVENING OF MEETING**

Not applicable.

598/2024-25 **MINUTES****Minutes of the Meeting Held on 19th February 2025**

The Chairman presented the **Minutes of the Planning and Environment Committee Meeting Held on 19th February 2025**, a copy of which had been previously circulated to all Councillors.

Having duly considered the afore-mentioned minutes, it was

337

PROPOSED BY: Councillor Carey
SECONDED BY: Councillor Houston

RESOLVED – that the Minutes of the Planning and Environment Committee Meeting held on 19th February 2025 be approved and signed as a true and correct record.

Councillor J Davies abstained from voting as he hadn't been present for the meeting.

599/2024-25 **PLANNING CLERK'S REPORT**

The Planning Clerk's report, which had been previously circulated to all Committee Members, was duly received and noted as below:

Changes to pricing on Planning Portal.

Email received from the Planning Portal advising of price increases with effect from 31st March 2025 and they are as follows:

1) The UK Government's increase to statutory planning fees from 1 April 2025, which raises costs across the sector, for all parties.
[Click here to find out more.](#)

2) Significant increases in the cost of processing planning applications,
including security, payment handling and associated fees, platform maintenance, and support services.

From 31 March 2025, the following will apply:
Updated Planning Portal Service Charge: £70.33 + VAT
Minimum Fee Threshold Increase: From £60 to £100 (applications under £100 will not incur a service charge).

Why is the service charge increasing?

This charge enables us to:

- ✓ Maintain and enhance **essential services** that support the entire planning and construction sector.
- ✓ Deliver **dedicated customer support** to assist applicants and planning professionals.

- ✓ Develop **innovative tools** and features, utilising **new emerging AI technologies** to streamline the application process for all users.
- ✓ Ensure **secure and efficient payment processing** for smoother transactions.

338

New Romney Highway Improvement Plan

Our next public engagement meeting regarding proposed double yellow lines for the junction of St Mary's Road and Fairfield Road has been scheduled for Saturday 22nd March 2025, from 10am to 12pm in the Assembly Rooms. Please save this date in your diaries. Please see working parties report for more information.

Planning Clerk – 05.03.2025

600/2024-25 **SCHEDULE OF PLANNING APPLICATIONS**

It was

PROPOSED BY: Councillor Coe
SECONDED BY: Councillor Rivers

RESOLVED UNANIMOUSLY – that NRTC Planning and Environment Committee comments, including those comments relating to additional planning applications received after publication of the agenda for this meeting, be submitted to FHDC Planning Department:

<u>Application No</u>	<u>Location and Description</u>
(i) <u>25/0219/FH</u>	9B Littlestone Road, Littlestone, New Romney, TN28 8LN
	Retention of existing detached Annex (extension to deadline requested)
<u>RECOMMENDATION</u>	No objection
<u>Voting:</u>	
For Application:	5
Against Application:	1
Abstained:	1

(ii) [25/0106/FH](#)12 High Street, New Romney,
TN28 8DDTwo storey building containing a
café and a 2 bed flat.**RECOMMENDATION****Recommend refusal -
concerns regarding over
development, lack of
details regarding commercial
ventilation, no EV parking,
concerns over lack of parking
– does not meet the required
amount of parking for
development, applicant
shouldn't be reliant on public
car park for business use.****Voting:****For Application:****0****Against Application:****7****Abstained:****0**(iii) [25/0325/FH](#)West Knoll, Lydd Road, New
Romney, TN28 8DH

Erection of a detached dwelling.

RECOMMENDATION**Recommend refusal –
contravenes HB1 due to roof
line being higher than
neighbouring properties,
concerns raised over
Southern Water comments
regarding lack of information
about foul surface water
drainage. Doesn't meet
KCC requirements as no
turning point for vehicles.****Voting:****For Application:****0****Against Application:****6****Abstained:****1**

(iv)	25/0380/FH/TCA	The Old Green, Madeira Road, Littlestone, New Romney, TN28 8QX
	<p><u>RECOMMENDATION</u></p> <p><u>Voting:</u></p> <p>For Application:</p> <p>Against Application:</p> <p>Abstained:</p>	<p>Works to trees in Conservation Area - Tree A Sycamore and Tree B Sycamore Fell to ground level.</p> <p>No objection</p> <p>7</p> <p>0</p> <p>0</p>
(v)	25/0384/FH	1 Brissenden Close, New Romney, TN28 8JD
	<p><u>RECOMMENDATION</u></p> <p><u>Voting:</u></p> <p>For Application:</p> <p>Against Application:</p> <p>Abstained:</p>	<p>Two Storey side extension and front entrance porch</p> <p>No objection</p> <p>7</p> <p>0</p> <p>0</p>
		341
(vi)	24/1901/FH	Plot C Coronet Park, Mountfield Road, New Romney, TN28 8LH
		<p>18 no. general industrial units all with associated parking and access road.</p> <p>This is a re-consultation following the submission of additional details or a change in circumstance.</p> <p>These are detailed below: Additional information received 04.03.2025</p>
	<p><u>RECOMMENDATION</u></p> <p><u>Voting:</u></p>	<p>No objection subject to KCC conditions being met regarding cycle spaces.</p>

For Application:	7
Against Application:	0
Abstained:	0

(vii) [25/0145/FH](#)

25 Cockreed Lane, New Romney TN28 8JH

Lawful development certificate (proposed) to use existing garden structure as an air bnb.

RECOMMENDATION

Recommend refusal due to lack of information regarding parking, no proof building has met requirements for air bnb, no EV charger point or cycle racks, no fire certificate. This is a material change of use and a full planning application should be applied for.

Voting:

For Application:	0
Against Application:	7
Abstained:	0

342

601/2024-25 **SCHEDULE OF LICENCE APPLICATIONS**

There were no licence applications for consideration.

602/2024-25 **FOLKESTONE & HYTHE DISTRICT COUNCIL REPORTS/ DECISIONS/MATTERS**

A schedule of delegated decisions of Folkestone & Hythe District Council Planning Department for the periods of 9th February 2025 & 23rd February 2025 were duly received and noted.

603/2024-25 **ENVIRONMENTAL MATTERS**

The Kent & Medway Air Quality Forecast for Sunday 17th March 2025 & The latest Water Quality Sampling Information which had previously been circulated to all Committee Members, was duly received and noted.

604/2024-25 **REPORTS FROM WORKING PARTIES**

The Parish Highway Improvement Plan working party report, which had been previously circulated to all Committee Members, was duly received and noted as below:

Parish Highway Improvement Plan

The next public engagement drop-in session has been scheduled for Saturday 22nd March 2025 see poster below for details, Councillors are encouraged to attend. This information will be shared on posters in our noticeboards and via the New Romney Town Council website and Facebook page. Those on our mailing list will also be invited to attend and contribute.

New Romney Town Council
Parish Highway Improvement Plan
Public Engagement
Proposed Double Yellow Lines
St Mary's Road Junction with Fairfield Road

The following date has been booked for a drop-in session at The Assembly Rooms, Church Approach, New Romney on:

Saturday 22nd March 2025 10:00am – 12:00pm.

Come along to chat to your Councillors and have your say regarding the proposed changes - please see below:

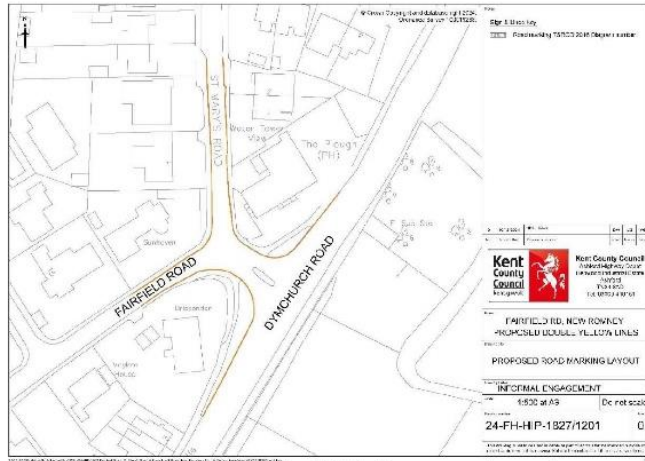

If you are unable to attend but would still like to have your say, please email:
planning.clerk@newromney-tc.gov.uk for a comments form.
Closing date for returning comments forms: 27/03/2025



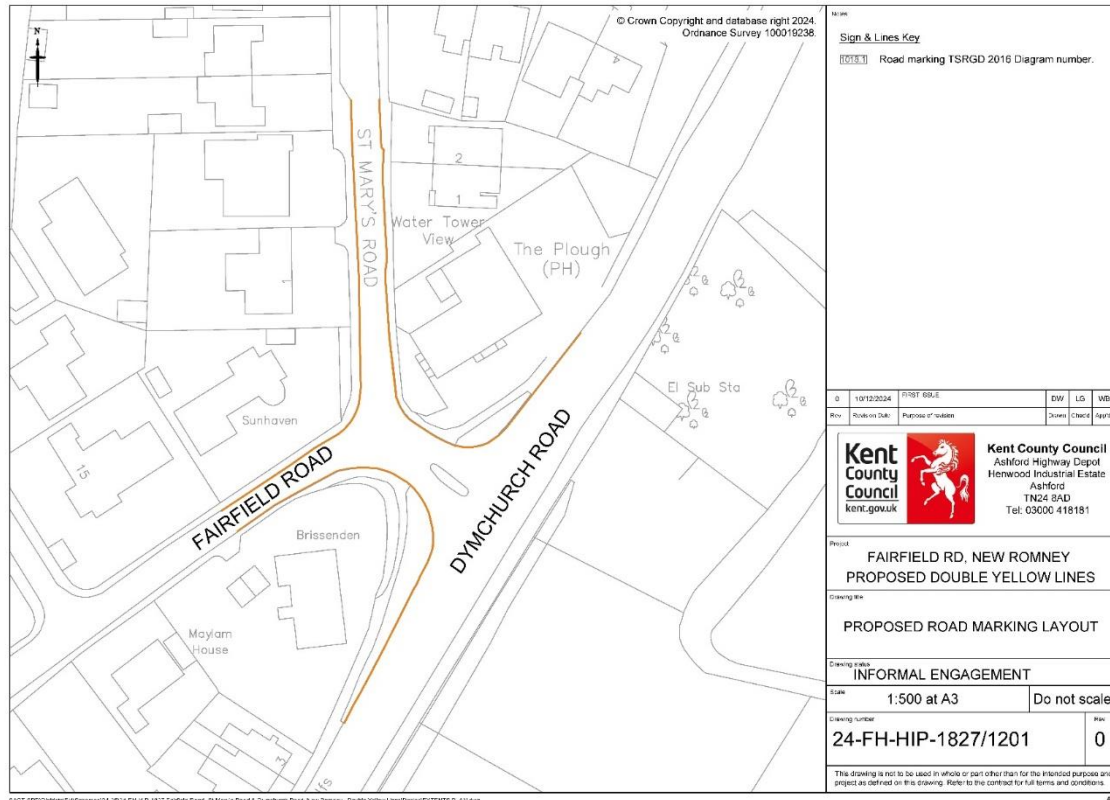

Speed Surveys For Remaining 20MPH Zones

The speed surveys for all remaining 20MPH zones commenced on the 8th March 2025. In total KCC have arranged for 19 x speed surveys to be conducted, the results can take up to one month to come back. Once KCC has the result back they will report back to NRTC and advise which roads within these zones are suitable for the proposed 20MPH limit.

Lydd Road – Proposed Double Yellow Lines

Update received from KCC it has been confirmed that double yellow lines are proposed for Lydd Road incorporating the junction with Sussex Road and Longshore Grove.

These plans have been drawn up by Kent County Council as part of the latest development agreement.

These plans have not yet gone through the Traffic Regulation Order stage, so it will be subject to passing the formal public consultation before it can be installed.

The designs with double yellow lines proposed are below and if this passes the TRO, this should address the issue with congestion on Lydd Road.

The Planning Clerk has asked if New Romney Town Council can have some input into the proposed plans or make any changes/recommendations. KCC will get the development team who drew the plans up to contact the Clerk to discuss if this is possible. I shall report back when I hear anything.

Please see proposed plans below:

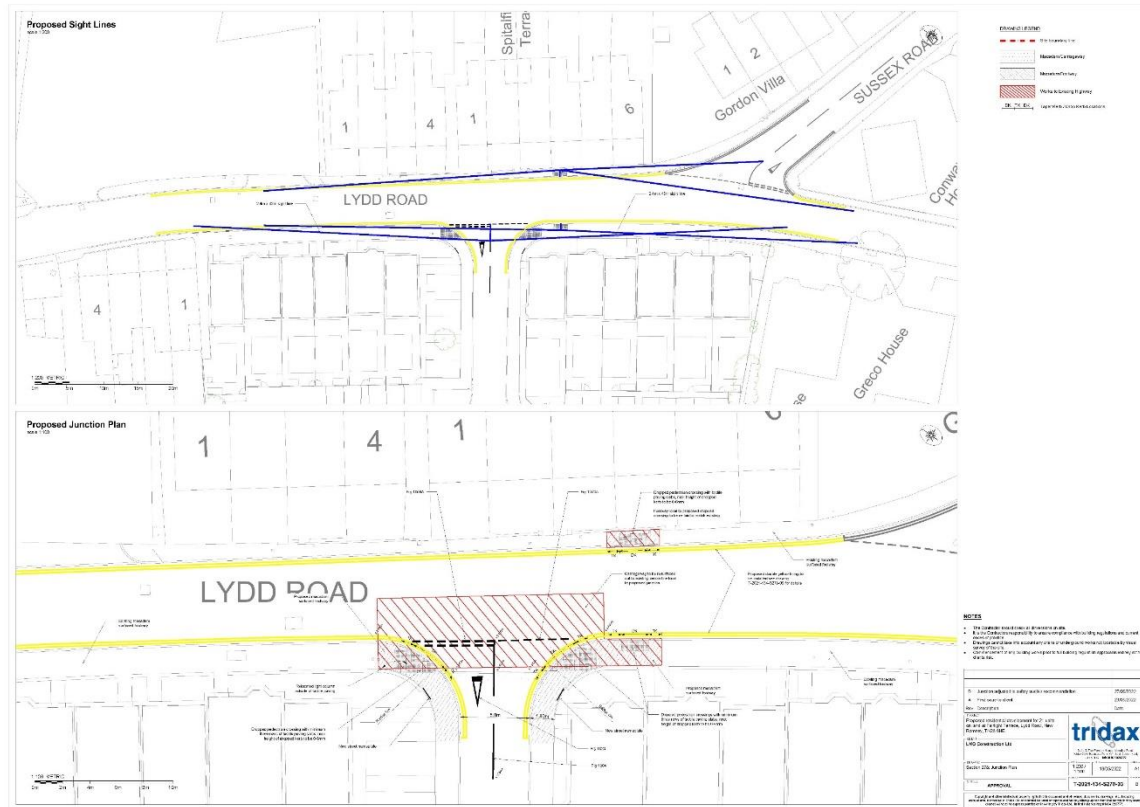

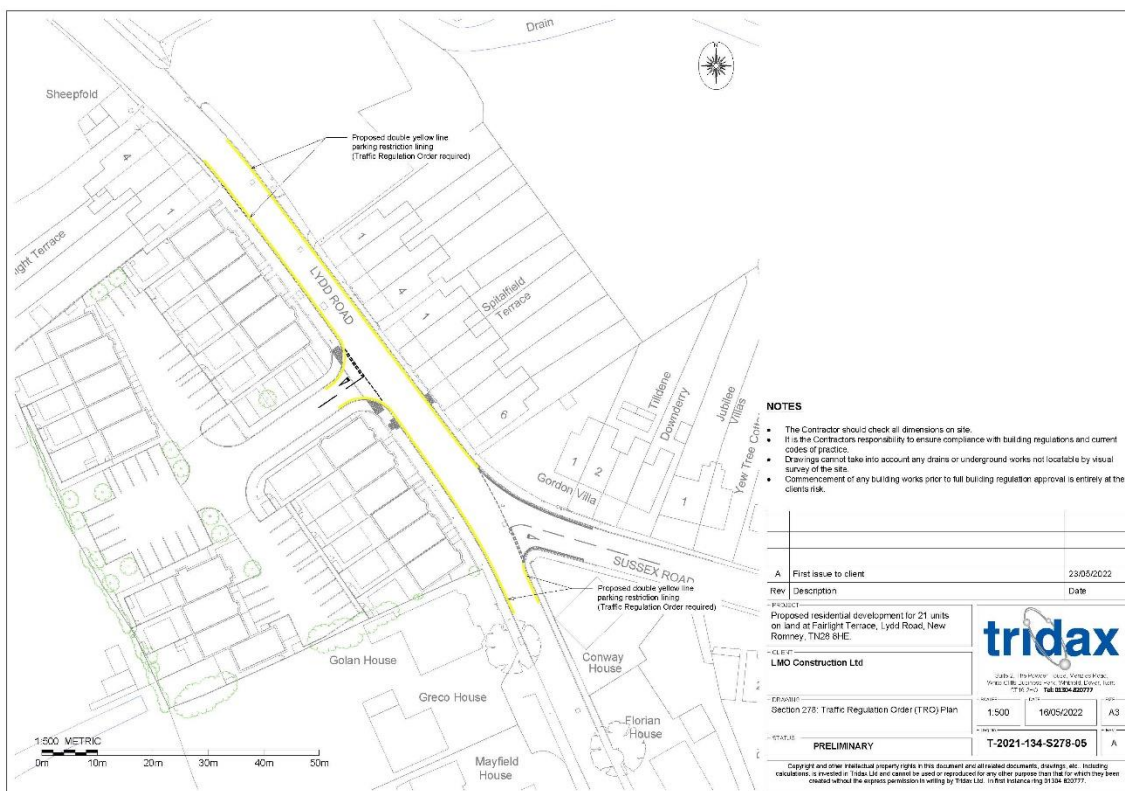

345

605/2024-25 FOLKESTONE AND HYTHE DISTRICT COUNCIL HERITAGE STRATEGY CONSULTATION

Having duly considered the afore-mentioned consultation, it was:

PROPOSED BY: Councillor Rivers
SECONDED BY: Councillor Coe

RESOLVED UNANIMOUSLY – that Councillor Terry complete the Consultation Questionnaire on behalf of The Planning and Environment Committee.

The Chairman thanked those present for their attendance and the meeting Concluded **at 7.42PM**

Minutes prepared by the Planning Clerk

NEW ROMNEY TOWN COUNCIL
PLANNING AND ENVIRONMENT COMMITTEE MEETING
2nd April 2025
PLANNING CLERK'S REPORT

Public Engagement for Parish Highway Improvement Plan -22.03.2025

See working parties for report.

NEW ROMNEY TOWN COUNCIL
PLANNING AND ENVIRONMENT COMMITTEE MEETING
2nd April 2025
SCHEDULE OF PLANNING APPLICATIONS
FOR CONSIDERATION

<u>Application No</u>	<u>Location and Description</u>
(i) <u>25/0147/FH</u>	Plot 16 Collins Road, New Romney. Lawful development certificate (proposed) to create additional vehicular access.
<u>RECOMMENDATION</u> <u>Voting:</u> For Application: Against Application: Abstained:	
(ii) <u>25/0448/FH/CON</u>	Pastoral fields west of Ashford Road, New Romney. Approval of details pursuant to condition 8(materials) of planning permission <u>23/1591/FH</u>
<u>RECOMMENDATION</u> <u>Voting:</u> For Application: Against Application: Abstained:	
Approved by FHDC 27/032025	
(iii) <u>25/0545/FH</u>	135 Queens Road, New Romney, TN28 8NA. Works to trees the subject of TPO No. 05 of 1994 - T1 Holm Oak - Crown reduction by a max of 3 meters. T2 Holm Oak - Section tree to ground level.
<u>RECOMMENDATION</u> <u>Voting:</u> For Application: Against Application: Abstained:	

(iv) [25/0560/FH/TCA](#)

Endeavour, Sussex Road, New Romney,
TN28 8HL

Works to trees in a Conservation area comprising of T1 & T2 Holm Oaks reduce by approx. 3 metres back to previous growth points, T3 Yew reduce to approx. 3 metres.

RECOMMENDATION

Voting:

For Application:

Against Application:

Abstained:

(v) [25/0524/FH/CON](#)

Sandbanks, Coast Road, Littlestone,
TN28 8RA.

Approval of details pursuant to condition 19 (electric vehicle charging point details) of planning permission [21/0747/FH](#)

RECOMMENDATION

Voting:

For Application:

Against Application:

Abstained:

Additional Plans Received:

(vi) [24/1190/FH](#)

Land to rear of Imogene, Station Approach,
Littlestone, New Romney, TN28 8LU.

Folkestone & Hythe District Council write to inform you that the following case has been appealed. [AP-6693](#)

2 LAND REAR OF IMOGENE, STATION
APPROACH, LITTLESTONE, NEW
ROMNEY, TN28 8LU

Appeal against refusal of [24/1190/FH](#) -
Change of use from holiday let to residential
dwelling including single storey side
extension.

The appeal will be determined on the basis of Written Representations. The procedure to be followed is set out in Part 2 of The Town and Country Planning (Appeals) (Written Representation Procedure)(England) Hearing. The procedure to be followed is set out in The Town and Country Planning (Hearings Procedure)(England) Rules 2000, as amended.

We have forwarded all the representations made to us on the application to the Planning Inspectorate and the appellant. These will be considered by the Inspector when determining the appeal.

If you wish to make comments, or modify/withdraw your previous representation, you can do so online at <https://acp.planninginspectorate.gov.uk>.

FHDC Decision - REFUSAL **REFUSAL REASONS**

1 The proposed development, by virtue of its position and cramped, restrictive plot size, would provide insufficient private external amenity space to serve the proposed dwelling, resulting in an unacceptable level of amenity for future occupants of the property, contrary to policy HB3 of the Places and Policies Local Plan 2020, which requires a minimum garden depth of 10 metres for new dwellings.

NRTC did not previously comment.

RECOMMENDATION

Voting:

For Application:

Against Application:

Abstained:

NEW ROMNEY TOWN COUNCIL
PLANNING AND ENVIRONMENT COMMITTEE MEETING
2nd April 2025

DELEGATED DECISIONS OF FOLKESTONE & HYTHE DISTRICT COUNCIL

For the period ending 9th March 2025

- | | | |
|-------|-----------------------------------|---|
| (i) | <u>25/0043/FH</u> | <p>95 St Nicholas Road, Littlestone, New Romney, TN28 8QA</p> <p>Front and Rear Dormers</p> <p><u>DECISION:</u> Approved with conditions
 NRTC – No objection</p> |
| (ii) | <u>25/0095/FH</u> | <p>17-19 Dunes Road, Greatstone, TN28 8SS</p> <p>Retrospective application for siting of InPost Parcel Locker.</p> <p><u>DECISION:</u> Refused-</p> <p>1) The parcel lockers, by virtue of their scale, design, and prominent siting represent an overly dominant, incongruous, and visually intrusive form of development within the street scene and causing adverse harm to the character and appearance of the area in a manner contrary to policy HB1 of the Places and Policies Local Plan.</p> <p>2) The parcel lockers, by virtue of their scale, design, and prominent siting to the front of the property and along the common boundary result in an unacceptably overbearing sense of enclosure and a loss of outlook for the occupiers of no. 21a Dunes Road in a manner contrary to policy HB1 of the Places and Policies Local Plan.</p> <p>NRTC – No objection</p> |
| (iii) | <u>25/0115/FH</u> | <p>UNIT 1, Heritage Court, Mountfield Road, Mountfield Industrial Estate, New Romney, TN28 8FA</p> <p>Proposed Extension</p> <p><u>DECISION:</u> Approved with conditions
 NRTC – No objection</p> |

For the period ending 16th March 2025

- (i) [25/0150/FH](#) Charelan, Warren Road, Littlestone, TN28 8PN

DECISION:

Lawful
NRTC – No objection

For the period ending 23rd March 2025

- (i) [25/0169/FH](#) Willows, Spitalfield Lane, New Romney , TN28 8HQ

DECISION:

Approved with Conditions – [DM40](#) Decision notice.
NRTC- recommend refusal – inadequate detail
provided to ascertain whether the application met
building regulations.

NEW ROMNEY TOWN COUNCIL
PLANNING AND ENVIRONMENT COMMITTEE MEETING
2nd April 2025
ENVIRONMENTAL MATTERS

Kent & Medway Air Quality Forecast for Tuesday 25th March 2025

Today	Air quality within the post code region TN28 is forecast to be predominantly Moderate with a slight possibility of Low
Tomorrow	Air quality within the post code region TN28 is forecast to be Low

The probability of pollution levels being within the four main bandings is shown in the table below.

Air Pollution Level	Today	Tomorrow
Low	15%	>95%
Moderate	85%	<5%
High	<5%	<1%
Very High	<1%	<1%

Recommended Actions and Health Advice

Air Pollution Banding	Value	Accompanying health messages for at-risk individuals*	Accompanying health messages for the general population
Low	1-3	Enjoy your usual outdoor activities.	Enjoy your usual outdoor activities.
Moderate	4-6	Adults and children with lung problems, and adults with heart problems, who experience symptoms , should consider reducing strenuous physical activity, particularly outdoors.	Enjoy your usual outdoor activities.

High	7-9	Adults and children with lung problems, and adults with heart problems, should reduce strenuous physical exertion, particularly outdoors, and particularly if they experience symptoms. People with asthma may find they need to use their reliever inhaler more often. Older people should also reduce physical exertion.	Anyone experiencing discomfort such as sore eyes, cough or sore throat should consider reducing activity, particularly outdoors.
Very High	10	Adults and children with lung problems, adults with heart problems, and older people, should avoid strenuous physical activity. People with asthma may find they need to use their reliever inhaler more often.	Reduce physical exertion, particularly outdoors, especially if you experience symptoms such as cough or sore throat.

*Adults and children with heart or lung problems are at greater risk of symptoms. Follow your doctor's usual advice about exercising and managing your condition. It is possible that very sensitive individuals may experience health effects even on Low air pollution days. Anyone experiencing symptoms should follow the guidance provided below.

Further information about health and air quality can be found here: <https://kentair.org.uk/faq>

Further details about current air quality and the forecast are available – [here](#)

Water Quality Sampling Information

Water Quality Sampling has now concluded for this year. All data collect and information has been uploaded onto New Romney Town Council's website:

https://www.newromney-tc.gov.uk/Water_Quality_Sampling_Information_48107.aspx

Understanding our data collected

Coastal Bathing Waters

Classification

Thresholds (percentile)

Excellent	EC: ≤250 cfu/100ml ;	IE: ≤100 cfu/100ml (95 th percentile)
Good	EC: ≤500 cfu/100ml ;	IE: ≤200 cfu/100ml (95 th percentile)
Sufficient	EC: ≤500 cfu/100ml ;	IE: ≤185 cfu/100ml (90 th percentile)
Poor	means that the values are worse than the sufficient	
(≤ means less than or equal to)		

For every designated bathing water in England, the Environment Agency monitors *Escherichia coli* (EC) and intestinal enterococci (IE) in the water, throughout the bathing season (15 May to 30 September).

Values can vary depending on the weather, pollution from agricultural and urban sources, storm water overflows, amongst other factors.

The readings taken over the last four bathing seasons then determine the annual classification for that water.

Escherichia coli (E.coli)

E. coli are a group of organisms found in the intestines of animals and humans and survive for a while in the environment when excreted. Many types of *E. coli* are not harmful but some such as *E. coli* 0157, can directly cause illness. The presence of the bacteria indicates that human or animal faeces may be present in bathing water and could contain other potentially harmful organisms that could cause illness.

Intestinal Enterococci (IE)

Intestinal Enterococci are found in the intestines of animals and humans although some types are environmental in origin. The presence of the bacteria indicates that human or animal faeces may be present in bathing water alongside other potentially harmful organisms that could cause illness.

NEW ROMNEY TOWN COUNCIL
PLANNING AND ENVIRONMENT COMMITTEE MEETING
2nd April 2025
REPORTS OF WORKING PARTIES

Please see updates below following a scheduled meeting held on 20.03.2025 with KCC for the Highway Improvement Plan:

Speed Surveys for Remaining 20MPH Zones

The data results from the speed surveys for the 20MPH zones are expected to be received within the coming week and this will be reported back to NRTC when they are available, there has been significant delays due to long term staff sickness.

There have also been some issues regarding placing signage due to the restrictive locations. However, it has been reported that the designs are in the advanced stage and are waiting to be checked and approved and are waiting costings to be finalised.

Update – Speed Survey Results

KCC have emailed the results for the speed surveys for remaining proposed 20MPH zones 3-6, please see report below:

Please note the average speed needs to be 24MPH and below to be able to install a 20MPH limit.

Grand Parade (30mph speed limit)							
Direction	Number of Vehicles	Average speed over 7 days	85 percentile speeds	Percentage of vehicles complying with the 30mph speed limit	Percentage of vehicles under enforcement threshold of 35mph	Percentage of vehicles complying with a proposed signed only 20mph speed	Percentage of vehicles complying with a proposed signed only 30mph speed
N0	24025	29.6mph	33.9mph	56.5% (13579)	89.1% (21401)	2.2% (529)	56.5% (13579)
S1	22660	29mph	33.2mph	62.4% (14131)	91.2% (20670)	2.6% (593)	62.4% (14131)
Coast Drive (30mph speed limit)							
Direction	Number of Vehicles	Average speed over 7 days	85 percentile speeds	Percentage of vehicles complying with the 30mph speed limit	Percentage of vehicles under enforcement threshold of 35mph	Percentage of vehicles complying with a proposed signed only 20mph speed	Percentage of vehicles complying with a proposed signed only 30mph speed
N0	20457	31.9mph	36.3mph	34.3% (7012)	78.1% (15978)	1.3% (270)	34.3% (7012)
S1	16600	31mph	35mph	42.1% (6994)	85.2% (14142)	1.6% (266)	42.1% (6994)
Adie Road (30mph speed limit)							
Direction	Number of Vehicles	Average speed over 7 days	85 percentile speeds	Percentage of vehicles complying with the 30mph speed limit	Percentage of vehicles under enforcement threshold of 35mph	Percentage of vehicles complying with a proposed signed only 20mph speed	Percentage of vehicles complying with a proposed signed only 30mph speed
E1	1201	19.4mph	24.2mph	98.8% (1187)	99.8% (1198)	54.1% (650)	98.8% (1187)
W0	1118	20.6mph	26mph	96.2% (1076)	99.6% (1113)	46.2% (516)	96.2% (1076)

Dunes Road (30mph speed limit)							
Direction	Number of Vehicles	Average speed over 7 days	85 percentile speeds	Percentage of vehicles complying with the 30mph speed limit	Percentage of vehicles under enforcement threshold of 35mph	Percentage of vehicles complying with a proposed signed only 20mph speed	Percentage of vehicles complying with a proposed signed only 30mph speed
N0	2043	20.1mph	24.7mph	98.6% (2014)	99.9% (2041)	46.5% (950)	98.6% (2014)
S1	1986	19.8mph	24.7mph	98.4% (1954)	99.7% (1981)	51% (1012)	98.4% (1954)
Church Road (30mph speed limit)							
Direction	Number of Vehicles	Average speed over 7 days	85 percentile speeds	Percentage of vehicles complying with the 30mph speed limit	Percentage of vehicles under enforcement threshold of 35mph	Percentage of vehicles complying with a proposed signed only 20mph speed	Percentage of vehicles complying with a proposed signed only 30mph speed
E0	7004	19.8mph	25.1mph	96.8% (6778)	99.3% (6952)	52.3% (3663)	96.8% (6778)
W1	2203	21.2mph	26.5mph	94.8% (2088)	99% (2182)	40.4% (889)	94.8% (2088)
Church Lane (30mph speed limit)							
Direction	Number of Vehicles	Average speed over 7 days	85 percentile speeds	Percentage of vehicles complying with the 30mph speed limit	Percentage of vehicles under enforcement threshold of 35mph	Percentage of vehicles complying with a proposed signed only 20mph speed	Percentage of vehicles complying with a proposed signed only 30mph speed
N0	3639	17.2mph	21.7mph	99.4% (3616)	99.9% (3637)	75.1% (2733)	99.4% (3616)
S1	4064	16.9mph	21.3mph	99.7% (4050)	100% (4062)	77.8% (3161)	99.7% (4050)
The Churchlands (30mph speed limit)							
Direction	Number of Vehicles	Average speed over 7 days	85 percentile speeds	Percentage of vehicles complying with the 30mph speed limit	Percentage of vehicles under enforcement threshold of 35mph	Percentage of vehicles complying with a proposed signed only 20mph speed	Percentage of vehicles complying with a proposed signed only 30mph speed
E1	2438	18.5mph	22.8mph	99.1% (2417)	99.9% (2436)	65.5% (1596)	99.1% (2417)
W0	5248	18.3mph	21.7mph	99.6% (5229)	100% (5247)	70.2% (3686)	99.6% (5229)
Mountfield Road NORTH (30mph speed limit)							
Direction	Number of Vehicles	Average speed over 7 days	85 percentile speeds	Percentage of vehicles complying with the 30mph speed limit	Percentage of vehicles under enforcement threshold of 35mph	Percentage of vehicles complying with a proposed signed only 20mph speed	Percentage of vehicles complying with a proposed signed only 30mph speed
N1	8894	21.1mph	25.5mph	97.1% (8634)	99.6% (8862)	38.7% (3446)	97.1% (8634)
S0	8830	21.4mph	25.7mph	97.2% (8582)	99.6% (8792)	36.1% (3189)	97.2% (8582)
Mountfield Road SOUTH (30mph speed limit)							
Direction	Number of Vehicles	Average speed over 7 days	85 percentile speeds	Percentage of vehicles complying with the 30mph speed limit	Percentage of vehicles under enforcement threshold of 35mph	Percentage of vehicles complying with a proposed signed only 20mph speed	Percentage of vehicles complying with a proposed signed only 30mph speed
N1	5128	24.2mph	29.2mph	88.2% (4521)	97.5% (5002)	20.1% (1029)	88.2% (4521)
S0	5671	25.7mph	30.4mph	83.2% (4718)	96.3% (5460)	11.5% (652)	83.2% (4718)
Queen's Road (30mph speed limit)							
Direction	Number of Vehicles	Average speed over 7 days	85 percentile speeds	Percentage of vehicles complying with the 30mph speed limit	Percentage of vehicles under enforcement threshold of 35mph	Percentage of vehicles complying with a proposed signed only 20mph speed	Percentage of vehicles complying with a proposed signed only 30mph speed
E1	1361	24.2mph	29.8mph	85.9% (1169)	95.9% (1305)	21.5% (293)	85.9% (1169)
W0	1634	25.4mph	32mph	77.3% (1263)	91.7% (1499)	19.7% (322)	77.3% (1263)

Littlestone Road (30mph speed limit)							
Direction	Number of Vehicles	Average speed over 7 days	85 percentile speeds	Percentage of vehicles complying with the 30mph speed limit	Percentage of vehicles under enforcement threshold of 35mph	Percentage of vehicles complying with a proposed signed only 20mph speed	Percentage of vehicles complying with a proposed signed only 30mph speed
E1	28156	29.2mph	33.3mph	62.3% (17540)	90.9% (25605)	2.5% (697)	62.3% (17540)
W0	28686	28.6mph	32.2mph	68.8% (19744)	94.3% (27048)	2.6% (755)	68.8% (19744)
St Nicholas Road (30mph speed limit)							
Direction	Number of Vehicles	Average speed over 7 days	85 percentile speeds	Percentage of vehicles complying with the 30mph speed limit	Percentage of vehicles under enforcement threshold of 35mph	Percentage of vehicles complying with a proposed signed only 20mph speed	Percentage of vehicles complying with a proposed signed only 30mph speed
E0	965	20.3mph	26.8mph	93.9% (906)	99.1% (956)	47.7% (460)	93.9% (906)
W1	680	21mph	27.5mph	92.4% (628)	99% (673)	44% (299)	92.4% (628)
Blenheim Road (30mph speed limit)							
Direction	Number of Vehicles	Average speed over 7 days	85 percentile speeds	Percentage of vehicles complying with the 30mph speed limit	Percentage of vehicles under enforcement threshold of 35mph	Percentage of vehicles complying with a proposed signed only 20mph speed	Percentage of vehicles complying with a proposed signed only 30mph speed
E0	1554	23.2mph	29.8mph	85.3% (1326)	96% (1492)	31.5% (490)	85.3% (1326)
W1	911	22.7mph	29.8mph	85.9% (783)	95.6% (871)	35.3% (322)	85.9% (783)
St Andrew's Road (30mph speed limit)							
Direction	Number of Vehicles	Average speed over 7 days	85 percentile speeds	Percentage of vehicles complying with the 30mph speed limit	Percentage of vehicles under enforcement threshold of 35mph	Percentage of vehicles complying with a proposed signed only 20mph speed	Percentage of vehicles complying with a proposed signed only 30mph speed
E1	1727	21.4mph	27.2mph	93.6% (1616)	99.2% (1714)	39.1% (675)	93.6% (1616)
W0	1822	22.4mph	27.6mph	92.9% (1693)	98.8% (1800)	31.6% (576)	92.9% (1693)
Marine Parade (30mph speed limit)							
Direction	Number of Vehicles	Average speed over 7 days	85 percentile speeds	Percentage of vehicles complying with the 30mph speed limit	Percentage of vehicles under enforcement threshold of 35mph	Percentage of vehicles complying with a proposed signed only 20mph speed	Percentage of vehicles complying with a proposed signed only 30mph speed
N1	1764	20.9mph	26.3mph	94.8% (1673)	98.8% (1743)	42.7% (754)	94.8% (1673)
S0	1596	20.7mph	25.8mph	96.2% (1535)	99.5% (1588)	43.9% (700)	96.2% (1535)
Victoria Road (30mph speed limit)							
Direction	Number of Vehicles	Average speed over 7 days	85 percentile speeds	Percentage of vehicles complying with the 30mph speed limit	Percentage of vehicles under enforcement threshold of 35mph	Percentage of vehicles complying with a proposed signed only 20mph speed	Percentage of vehicles complying with a proposed signed only 30mph speed
E1	744	17.6mph	22.3mph	98.9% (736)	99.6% (741)	74.1% (551)	98.9% (736)
W0	741	18mph	22.3mph	98.7% (731)	99.6% (738)	71.9% (533)	98.7% (731)

Littlestone Road, Grand Parade and Coast Drive are not getting the average speed needed for a 20mph limit so won't be included. This will be consistent with The High Street, allowing a main route through New Romney with a 30mph limit, and the 20mph zones either side. Queen's Road and the south of Mountfield Road are just over the 24MPH so KCC may be able to incorporate some additional road marking measures in these areas to negate this.

Essentially the surveys are in support of the rest of the zones apart from Littlestone Road, Grand Parade & Coast Drive.

KCC would like to know how NRTC wish to proceed, and which zones the working party wish to work on, and then KCC can arrange for some more extents plans for NRTC to conduct an informal engagement regarding this.

Lydd Road – Proposed Double Yellow Lines

The Planning Clerk has previously asked if New Romney Town Council can have some input into the proposed plans or make any changes/recommendations. KCC has contacted the development team but has not had a reply. It is suspected that at this stage in the design phase it could be too late to revise the proposed plans but there is a possibility to request an amendment to them after installation through the Highway improvement plan.

Update 26th March 2025- KCC have requested again that the officer from the Development team contact NRTC about the double yellow lines around Longshore Grove.

St Mary's Road and Fairfield Road Junction - Proposed Double Yellow Lines drop in Session data and report

There was a drop-in Session for the proposed double yellow lines for St Mary's Road and Fairfield Road junction held on Saturday 22nd March 2025 at The Assembly Rooms. It was well attended by residents and members of the public, with twenty-one in total attending. To date NRTC have received twenty-two public comment forms for consideration and they are unanimously in favour of the proposal. A lot of the comments included suggestions for the proposed double yellow lines to be extended to neighbouring roads, with Walner Lane and Walner Gardens. This information has been recorded and will be sent to KCC for consideration.

There were other highway concerns raised by members of the public, these will be reported and discussed at the next Parish Highway Improvement Plan working party meeting.



Highway Improvements Team working in Partnership with New Romney Town Council Highway Improvement Plan

Submission Date: December 2022

(Please remember that the HIP is for new initiatives/measures/schemes in your community – it is NOT to be used as a maintenance log, as these MUST be logged using the online reporting tool via this link <https://www.kent.gov.uk/roads-and-travel/report-a-problem>)

HIP Front Cover

HIP Version	Submitted by (Name)	HIP Date	Record Of Meeting Dates with KCC Virtual or Face to Face	County Member	
1					
Please list below the funding opportunities/Sources for HIP initiatives/Measures				I.e., County Member, Parish Precept Donation, LTP	
Are you an active member of the Speed Watch Scheme?		Yes <input type="checkbox"/> No <input checked="" type="checkbox"/>	Are you an active member of the Lorry Watch Scheme?		
			Yes <input type="checkbox"/> No <input checked="" type="checkbox"/>		
Name of HIP Representative		Contact Telephone Number		Email Address	
Name of Clerk	Planning Clerk – Mrs Gemma Hall	Contact Telephone Number	01797 362348 01797 740161	Email Address	planning.clerk@newromney-tc.gov.uk
Name of Chair		Contact Telephone Number		Email Address	
KCC Project Manager Team	Community & Engagement Team (EAST)	Contact Telephone Number	03000 418181	Email Address	east.highwayimprovements@kent.gov.uk

- Please note the Priority column MUST be those issues which are regarded as the most important (No 1 being your highest priority, then filtering down)
KCC is unable to guarantee that all your requests will be deliverable, but Project Managers can investigate your top 1 or 2 priorities per year.

Please Note: Highway Improvement Plans will only be accepted if they are in this prescribed template format. **PLEASE DO NOT ALTER IN ANY WAY.**
Whilst this is intended to be a living document for your Parish Council, KCC can only make resources available to review your HIP annually –
XXXX's review is on or after XXXX each year.



Highway Improvements Team working in Partnership with New Romney Town Council Highway Improvement Plan

Live Priorities Record

Priority	Location	USRN	Problem/Concern	What do you feel are the potential solutions?	KCC Comments (This column is to be completed by Project Manager ONLY)
1.	Please see 20 MPH zones 1-6 attached.		Speeding	20 MPH zones	<p>02/02/2023-</p> <p>KCC and PC agreed to focus on Zones 1 & 2 as a priority.</p> <p>As above, traffic survey locations to be determined by KCC.</p> <p>18/10/2023-</p> <p>Traffic survey results are mostly in support of a 20mph limit for the majority of Zones 1-2, however the eastern side of Cockreed Lane has average speeds that are too high.</p> <p>For KCC to discuss options with PC at meeting on 01/11/2023</p> <p>01/11/2023-</p> <p>All average speeds from the surveys are in support of the a 20mph limit for Zones 1 & 2, except for the eastern end of Cockreed Lane which were 28mph. This is higher than we would like, and it is unlikely that we would get compliance without physical measures, however these measures are usually not popular with residents due to noise, they are expensive, and they require a system of street lighting. We are unsure at this time if the streetlighting present would be adequate enough to be classed as a safe system.</p> <p>KCC to produce an extents plan for PC to conduct further informal engagement with residents and provide KCC with responses.</p> <p>KCC to look at options regarding upgrades to school signage.</p> <p>19/11/2024</p> <p>TRO passed and invoice paid for detailed design for 20MPH zone for Phase 1.</p>

Highway Improvements Team working in Partnership with New Romney Town Council

Highway Improvement Plan

					<p>14/01/2025-</p> <p>Zones 1 & 2 in design phase.</p> <p>KCC to progress traffic surveys for zones 3-6 to assess feasibility.</p> <p>KCC to ascertain if Joseph's Way and surrounding roads as part of the new estate are publicly maintainable or not as this will effect the boundaries of the 20mph limit if feasible.</p>
2.	High Street, New Romney		Inconsiderate/Bad Parking - Causing Congestion.	Red lines needed to improve traffic flow and pedestrian safety.	<p>02/02/2023-</p> <p>Not feasible as this is only conducted in London.</p> <p>Changes to High Street Parking being actioned by Folkestone and Hythe District Council</p> <p>19/11/2024 – Changes to High Street Parking design by Folkestone and Hythe District Council has been through public consultation and passed by the JTB.</p> <p>Traffic Regulation Order passed and the changes are being implemented by FHDC contractors– hoping for completion prior to Christmas 2024.</p> <p>14/01/2025-</p> <p>PC waiting for the parking restrictions to be completed by FHDC. As this is being actioned by FHDC with no need for KCC action, this has been moved to the historical list.</p>
3.	i) Queens Road ii) Littlestone Road/Station Road iii) Coast Road iv) The Churchlands		Speeding.	Enhanced vehicle activated signs or traffic calming measures needed.	<p>02/02/2023-</p> <p>Did not discuss as prioritising above.</p> <p>14/01/2025-</p> <p>Traffic surveys to be conducted as part of the investigation into the 20mph zones. These can also be used to assess for either a Speed Indicator Device (SID) or a Vehicle Activated Sign (VAS). Full information sent to PC for consideration but main points are below:</p> <p>These devices are to be funded by the PC (Rough estimate</p>

Highway Improvements Team working in Partnership with New Romney Town Council

Highway Improvement Plan

					<p>of £10,000-£15,000) These devices cannot be used in 20mph limits, so cannot be used in conjunction with the 20mph zones if feasible We need to evidence the justification for their use and have approved locations The SID needs to be moved at least every 8 weeks between a minimum of 3 sites by volunteers</p> <p>PC informed KCC of development set at the end of Victoria Road West which will put more traffic onto the surrounding area.</p> <p>KCC to discuss this with the Development Team to see if any agreements are in place and whether any traffic calming or speed reductions are agreed for the area.</p> <p>PC mentioned issues on A259 by Longshore Grove whereby a disabled bay has been installed by FHDC in the same location as a controlled crossing is set to be installed by the developer.</p> <p>KCC to inform the Development Team of the issue to liaise direct with PC.</p>
4.	Fairfield Road junction with St Mary's Road, New Romney		Problem parking	Double yellow lines require around the junction	<p>19/11/2024</p> <p>KCC is currently drawing up extents plan for this that NRTC will take to public consultation.</p> <p>14/01/2025-</p> <p>Awaiting for the extents plans to be checked and approved before sending to PC for informal engagement</p>
5.	Coast Drive near Spar Greatstone/Clark Road.		Pedestrian crossing requested due to speeding and increase in pedestrians/visitors to The Green's.	The Green's is already a very popular destination for local residents and tourists/holiday makers visiting the play park and beach. New development on The Green's at Littlestone of the extension of the beach huts will cause more visitors.	<p>02/02/2023-</p> <p>Did not discuss as prioritising above.</p> <p>14/01/2025-</p> <p>KCC to review signage and road markings on Coast Drive</p>



Highway Improvements Team working in Partnership with New Romney Town Council Highway Improvement Plan

					<p>and propose improvements to PC.</p> <p>KCC to discuss PC's request for a controlled crossing by the park on Coast Drive with the Planning & Advice Team</p>
--	--	--	--	--	--



Highway Improvements Team working in Partnership with New Romney Town Council

Highway Improvement Plan

Historical Priorities Record

No	Location	USRN	Problem/Concern	What do you feel are the potential solutions?	KCC Comments
	High Street, New Romney		Inconsiderate parking	Red lines needed to improve traffic flow and pedestrian safety.	02/02/2023- Not feasible as this is only conducted in London. Changes to High Street Parking being actioned by Folkestone and Hythe District Council
	All roads		Double yellow line review – Many lines in our Parish are faded and need repainting and possibly extending.		02/02/2023- Any faded lines should be reported online via https://www.kent.gov.uk/roads-and-travel/report-a-problem Any extension to double yellow lines will need to be considered on a case by case basis.
	i) St Nicholas School – Fairfield Road, New Romney, TN28 8BP, Craythorne Lane & Rolfe Lane, New Romney. ii) The Marsh Academy – Station Road, New Romney, TN28 8BB See School Zone map attached.		Speeding and problem parking. Cars driving too fast near the school. Speed limit is currently 30MPH by both schools. Parent's parking on double yellow lines and blocking driveways. No crossing for St Nicholas School.	School Zones required.	02/02/2023- St Nicholas School is incorporated into Zone 2 of PC plans for 20mph zone. For a formal crossing point, both a traffic survey and pedestrian survey would need to be conducted to ascertain feasibility. KCC estimate at least £30,000 for a formal crossing (subject to fluctuation with cost of materials constantly changing) Traffic surveys to be conducted throughout Zone 1 & 2. KCC to determine locations and obtain cost of these surveys along with pedestrian survey. Vehicles parking on double yellow lines and blocking driveways are for enforcement by F&H and police.



Highway Improvements Team working in Partnership with New Romney Town Council Highway Improvement Plan

					PC advise that there are current plans for double yellow lines in the area.
					KCC has sent PC information on the School Travel Plan to share with both schools. 18/10/2023- Traffic and Pedestrian survey results have been analysed and unfortunately does not meet the minimum criteria for the installation of a formal crossing point.

Highway Improvements Team working in Partnership with New Romney Town Council

Highway Improvement Plan

<p>i) High Street ii) Church Lane iii) Church Road vi) The junction of Ashford Road onto The High Street. v) Station Road, Littlestone Road, Marsh Avenue, Blenheim Road, St Martins Road, The Churchlands, Marsh Crescent, Wiles Avenue, and Carey Close</p>		<p>Problem parking – causing congestion. i) Vehicles parking on Double Yellow lines outside Premier Stores near Tritton Lane causing a bottle neck in The High Street which causes delays and congestion due to the heavy flow of traffic. Larger vehicles struggle to get through the gap. ii) Vehicles parking on double yellow lines near Church Lane Surgery/The Old School House. iii) Vehicles parking on double yellow lines, blocking driveways, creating bottlenecks, and causing congestion especially near The Old School. iv) Vehicles parking on double yellow lines near junction opposite Oak Hall Surgery causing bottlenecks and congestion. v) Vehicles parking on grass verges/pathways.</p>	<p>i) Relocation of 'Coach Parking' bay from opposite the garage on the Highstreet to somewhere more suitable: Mountfield Ind Est or The Marsh Academy Car Park to free up parking spaces for other vehicles including an additional disabled bay. The new car parking bays should have time limits on them. To stop vehicles parking outside Romney Cycles – Premier Store side of the High Street to allow free flow of traffic – double yellow lines/red lines. Stagecoach have changed their timetable for New Romney High Street buses which was due to congestion. v) Bollards on grass verges needed.</p>	<p>02/02/2023-</p> <p>PC to liaise with F&H Council regarding the "Coach Parking Bay"</p> <p>PC advised that buses and HGVs are struggling to manoeuvre past each other as there are pinch points caused by vehicles parking on both sides of High Street.</p> <p>PC requested double yellow lines from Esso garage down to Premier Shop to allow free flow of traffic, with parking available with restricted time limits opposite.</p> <p>KCC to seek advice on this and come back to PC.</p> <p>PC reported issue with delivery of gas bottles on Ashford Road whereby the driver parks on the pavement, blocking it for pedestrians, and causing vehicles on the other side to drive on the pavement to get around.</p> <p>PC requested bollards but suspect that the pavement is not wide enough.</p> <p>KCC to measure pavement and ascertain options.</p> <p>01/11/2023-</p> <p>PC to continue with F&H District Council in regards to the Coach Bay and subsequent installation of double yellow lines by the Esso petrol station.</p>
---	--	---	---	--



Highway Improvements Team working in Partnership with New Romney Town Council

Highway Improvement Plan

					<p>PC reporting a crash issue at the junction of Ashford Road and High Street (A259). Crash data at this time shows one slight injury collision that occurred December 2022 where a vehicle overshot the STOP junction and collided with another.</p> <p>PC to report maintenance issues with lining via https://www.kent.gov.uk/roads-and-travel/report-a-problem</p> <p>PC requested an advanced STOP sign to be installed just before the buildings on the nearside. KCC have visited the site and there is an advanced STOP sign already present with a distance plate.</p> <p>PC also proposed a buildout by the junction, however High Street unfortunately does not have the available width to install one here.</p> <p>Moved to historical as no further options at this junction, and Coach Bay issues being dealt with by F&H.</p>
	Lydd Road – A259 – Outside Spitalfield Terrace.		Problem parking. Vehicles parking outside Spitalfield Terrace on the A259 as you go into New Romney. This causes major congestion due to a bottleneck/single file traffic and as consequence waiting vehicles then cut down Spitalfield Lane.	Due to the new development happening opposite Spitalfield Terrace a pedestrian crossing is due to be installed which should prevent the cars from parking on the A259. However there will inevitably still be cars that park there and cause an obstruction and a long term solution needs finding.	<p>02/02/2023-</p> <p>Did not discuss as prioritising above.</p> <p>01/11/2023-</p> <p>PC to liaise with Development Agreements team via DevelopmentAgreements@kent.gov.uk</p> <p>If unable to have measures agreed with the developer to alleviate this issue, for PC to raise again for Highway Improvements to discuss</p>
	High Street, New Romney		Inconsiderate/Bad Parking - Causing Congestion.	Red lines needed to improve traffic flow and pedestrian safety.	<p>02/02/2023-</p> <p>Not feasible as this is only conducted in London.</p> <p>Changes to High Street Parking being actioned by Folkestone and Hythe District Council</p> <p>19/11/2024 – Changes to High Street Parking design by Folkestone and Hythe District Council has been through</p>



Highway Improvements Team working in Partnership with New Romney Town Council Highway Improvement Plan

					<p>public consultation and passed by the JTB.</p> <p>Traffic Regulation Order passed and the changes are being implemented by FHDC contractors– hoping for completion prior to Christmas 2024.</p> <p>14/01/2025-</p> <p>PC waiting for the parking restrictions to be completed by FHDC. As this is being actioned by FHDC with no need for KCC action, this has been moved to the historical list.</p>
	Dymchurch Road		Speeding.	Extend the 30 MPH speed limit up to Marlie Farm.	<p>02/02/2023-</p> <p>Did not discuss as prioritising above.</p> <p>14/01/2025-</p> <p>KCC not in support of a speed reduction here as believes that 40mph is the most appropriate for the environment.</p> <p>KCC explained that by reducing the speed limit below what the environment would suggest to the average driver as the most appropriate, we risk having the opposite effect and see higher average speeds, an increased amount of inappropriate and dangerous overtaking, and therefore an increased risk of injury collisions occurring.</p> <p>The built up environment here is typical of a 40mph limit with it being built up on one side with houses set back.</p> <p>Average speeds for this section of the road are approximately 33mph which suggests good compliance currently, and there are no collisions in the last 3 years related to speed.</p>
	i) Spitalfield Lane Fairfield Road		Poor visibility.	Improve highway lighting for all roads without engineered footpaths.	<p>02/02/2023-</p> <p>Did not discuss as prioritising above.</p> <p>14/01/2025-</p>



Highway Improvements Team working in Partnership with New Romney Town Council Highway Improvement Plan

					There is currently street lighting in place in these areas, and an improvement to this lighting will be an incredibly costly scheme. No evidence to support this at this time.
--	--	--	--	--	--

END